

Call Toll Free  
800-245-0396

sales@flexospan.com



Expanding Menu

Up | Next | Search | Site Map | **Product Quick View**

- Home
- Metal Roofing and Siding Panels
- Purlin and Girt
- B Deck
- Self Storage Buildings
- Pre Engineered Metal Buildings
- Retrofit Roofing
- Customer Service

Flexospan ARCAT



Contact Info

**Flexospan**  
Steel Buildings, Inc.

Address

P.O. Box 515  
253 Railroad St.  
Sandy Lake, PA  
16145

Phone

800.245.0396  
724.376.7221

Fax

724.376.3864

E-Mail

sales@flexospan.com

Z Purlin & Girt

C Purlin & Girt

Purlin & Girt Clips

Accessories

## Z Purlin and Z Girt Structural Steel

### Wind, Snow, & Weight Tables

Flexospan provides standard, even-profile Z purlins and Z girts as well as custom profiles and punching patterns. We manufacture any component from 1/2" subgirts to 12" section up to 10 gauge. Z purlins and Z girts are also available with other depths and flange widths. Contact Flexospan for information on custom purlin and girt structural steel dimensions.

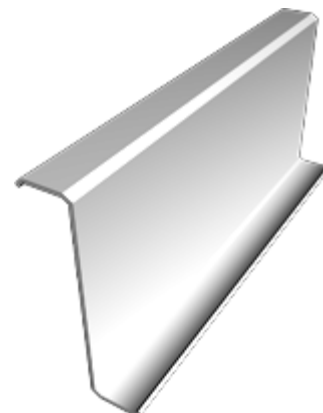

In this section you'll find sample calculations for determining wind and snow loads as well as Z purlin and Z girt weight tables.

- [C AND Z SPAN LOAD TABLE](#)
- [Z PURLIN AND GIRT SECTION PROPERTIES](#)
- [STANDARD HOLE PUNCHING PATTERNS](#)

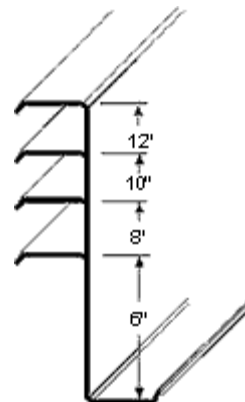

(Blank form to layout hole punching patterns)

### Sample Calculations

Calculation	Formula	Example
Wind load (sizing girts)	Wind load (lbs/sq ft) x .75 x girt spacing (ft) x wind coefficient (typically 1.1) = Allowable load/linear foot of girt	20 psf x .75 x 5 Ft x 1.1 = 82.5 plf
Live (snow) Load (load on purlin)	Snow load (lbs/sq ft) x purlin spacing (ft) = allowable load/linear foot of purlin	20 psf x 5 ft = 100 plf

*Note:* These sample calculations are basic. Many different variables can affect loading. For example, drift loading, building height, geographic location, etc. Please contact Flexospan if special conditions exist.

### Z Purlin and Z Girt Weight Table: Weight per Linear Foot

Size (nom)	16 Gauge		14 Gauge		12 Gauge	
	2 1/2" FI	3 1/2" FI	2 1/2" FI	3 1/2" FI	2 1/2" FI	3 1/2" FI
6" Cee	2.656	N/A	3.281	N/A	4.531	N/A
8 " Cee	3.099	3.541	3.828	4.375	5.286	6.041
10" Cee	3.541	3.984	4.375	N/A	6.041	6.797
12 " Cee	3.984	N/A	4.922	5.468	6.797	7.552

*Note:* These weights are for three or more spans based on uniform bay spacings. Contact Flexospan for help on calculating weights for non-uniform bays.



[Home](#)

[Up](#) | [Next](#) | [Search](#) | [Site Map](#) | [Product Quick View](#)

Copyright © 1969-2013 | Flexospan Steel Buildings, Inc.™ | All Rights Reserved® | [Legal Notices](#)